

2-way Ball Valve S4 Pneumatic Actuator



General:

- Body material: PVC, PP, PVDF
- Sealing material: EPDM, FPM
- Ball seating joint: PTFE
- Dimensions: DN10 – DN80
d20 – d110
1/2" – 4"

Operating pressure:

- PVC PN6 – PN10
- PP PN6 – PN10
- PVDF PN6 – PN10

End Connections:

- PVC solvent socket in DIN, ASTM, JIS
- PVC solvent spigot in DIN
- PVC, PP, PVDF threaded socket in BSP/NPT
- Flanges in DIN, ANSI, JIS, BS
- Fusion socket in PE, PP & PVDF
- Fusion spigot in PE, PP & PVDF

Type of actuator: piston actuator with 2 opposed pistons above tooth rack, elastic seal

Material of actuator:

- Body: aluminium anodised
- End caps: aluminium epoxy powder coated
- Screws and nuts: stainless steel

Control air: filtered air according to PNEURO/ISO class 4

Mounting position: any possible direction

Control function/control pressure:

- DA: double acting/ max. 10 bar
- SR: spring return/ max. 8 bar

Rotation angle: 90°, adjustment in both directions from –10° to +10°

Installation:

- Actuator – valve: ISO 5211
- Actuator – solenoid valve: NAMUR (VDI/VDE3845)
- Actuator – limit switch box: NAMUR (VDI/VDE3845)

Accessories:

- limit switch box
- 3/2 and 5/2 solenoid valves

This print contains no warranty promise, but it should give you some first information. The product range is extended continuously, therefore the versions and types correspond to the actual status of printing. Subject to technical modifications!



2-way Ball Valve S4 Pneumatic Actuator



Dimensions:

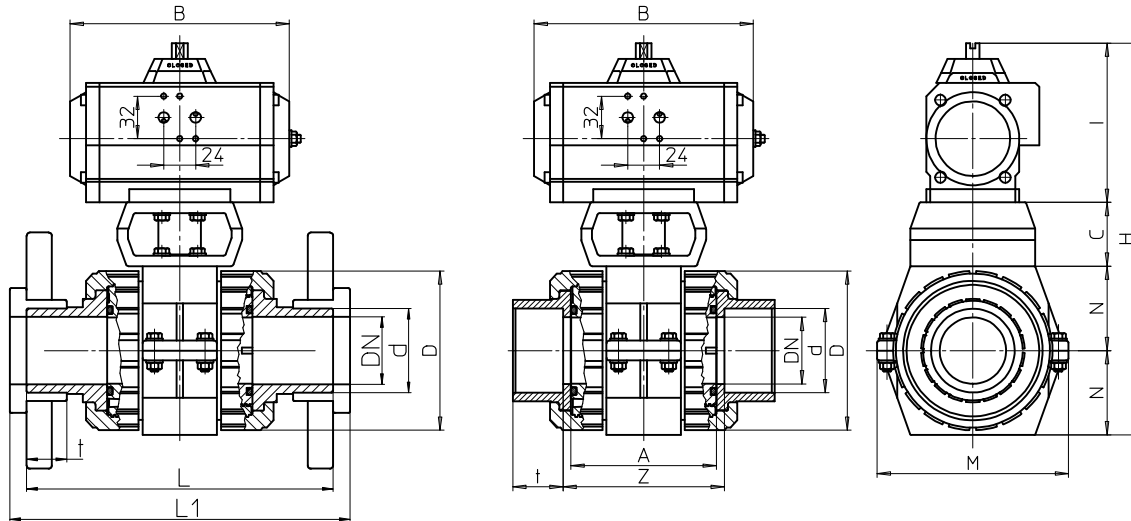

d	16	20	25	32	40	50	63	75	90	110
DN	10	15	20	25	32	40	50	65	80	80
G	3/8"	1/2"	3/4"	1"	1 1/4"	1 1/2"	2"	2 1/2"	3"	4"
A	62	62	70	74	84	95	109	137	163	163
C	38	38	38	38	48	48	48	72,5	72,5	72,5
D	53	53	63	70	85	101	121,5	155	188	188
M	112	113	113	113	144	144	144	204	204	204
N	33	33	40	43	51	56	64	85	100	100
L	114	124	144	154	174	194	224	284	300	340
L1	120	130	150	160	180	200	230	290	310	350
t	16,5	16,5	19,5	22,5	26,5	31,5	38,5	45	55,5	64
Z	67,5	67,5	76	81	90	104	121	148	183	176
PN PVC	10	10	10	10	10	10	10	6	6	6
PN PP	10	10	10	10	10	10	10	6	6	6
PN PVDF	10	10	10	10	10	10	10	6	6	6

Actuator	UT-05 DA				UT-15 DA				UT-17 DA	
B	119	119	119	119	165	165	165	165	197	197
H	205	205	219	225	271	281	297	363,5	393,5	393,5
I	101	101	101	101	121	121	121	121	121	121
Actuator	UT-05 SR				UT-15 SR		UT-17SR	UT-25 SR	UT-30 SR	
B	119	119	119	119	165	165	197	239	230	230
H	205	205	219	225	271	281	297	363,5	434,5	434,5
I	101	101	101	101	121	121	121	143	162	162

*Measurements can deviate slightly from the above!



2-way Ball Valve S4 Pneumatic Actuator



Exploded diagram:

- 01. pneumatic actuator
- 02. coupling
- 03. screw
- 04. washer
- 05. console
- 06. tooth lock washer
- 07. nut
- 08. valve bracket
- 09. ball valve
- 10. tooth lock washer
- 11. screw
- 12. hex head screw
- 13. washer
- 14. nut

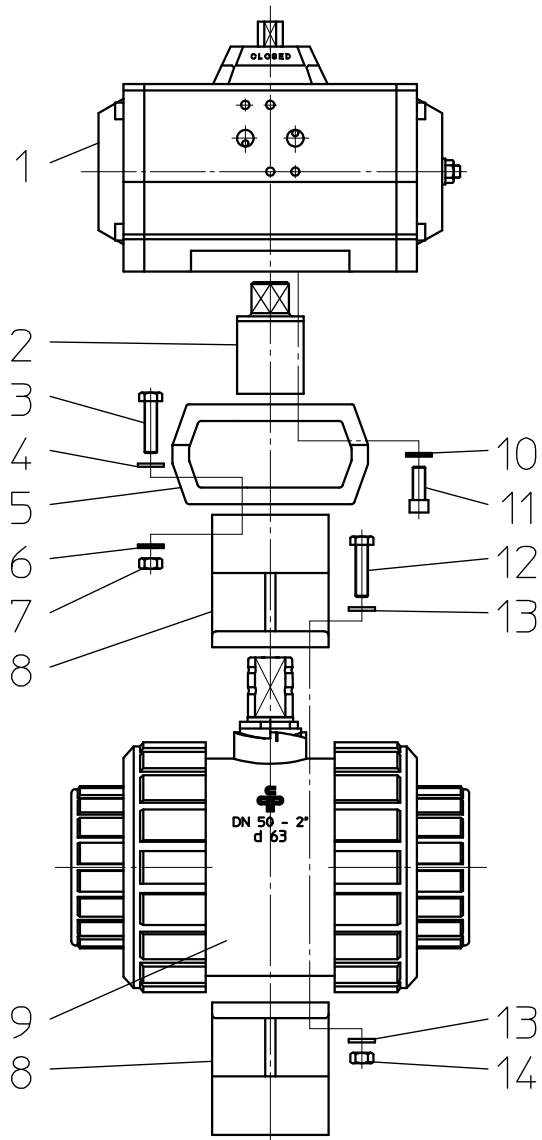

2-way Ball Valve S4 Pneumatic Actuator



Diagrams:

Flow – Pressure Loss - Diagram

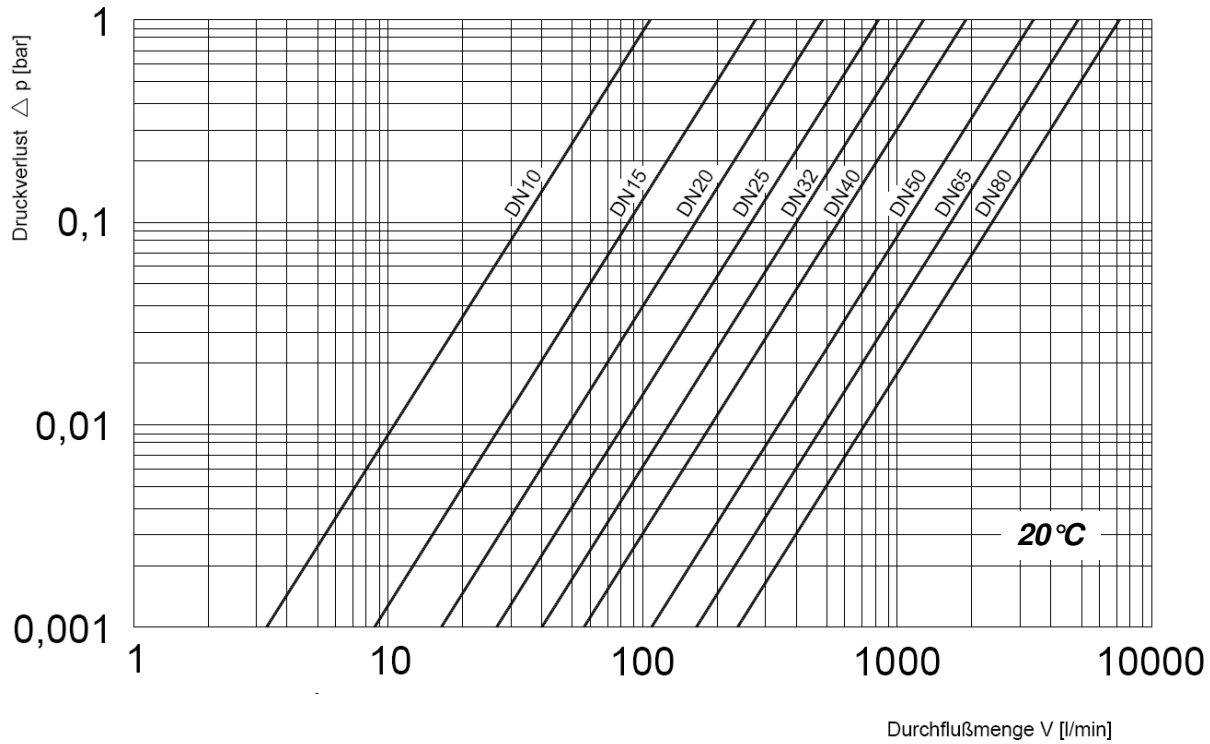

<i>cv Value Table</i>		
Pressure loss	1 bar	0,001 bar
DN 10	107 l/min	3,4 l/min
DN 15	278 l/min	8,8 l/min
DN 20	509 l/min	16,1 l/min
DN 25	843 l/min	26,7 l/min
DN 32	1269 l/min	40,1 l/min
DN 40	1858 l/min	58,7 l/min
DN 50	3424 l/min	110 l/min
DN 65	5133 l/min	165 l/min
DN 80	7455 l/min	240 l/min



2-way Ball Valve S4 Pneumatic Actuator

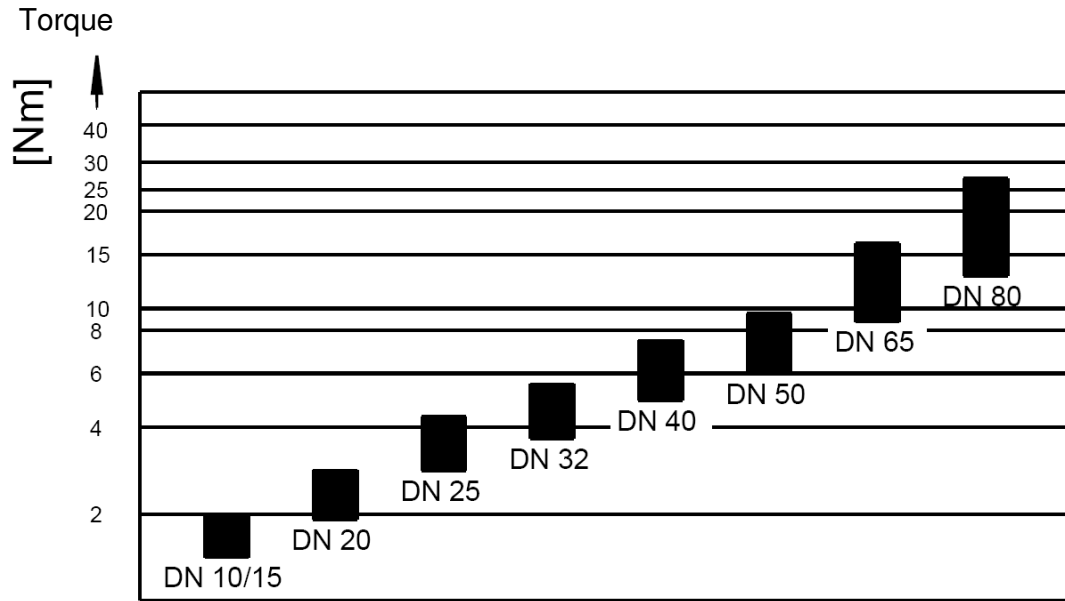

Flow characteristic

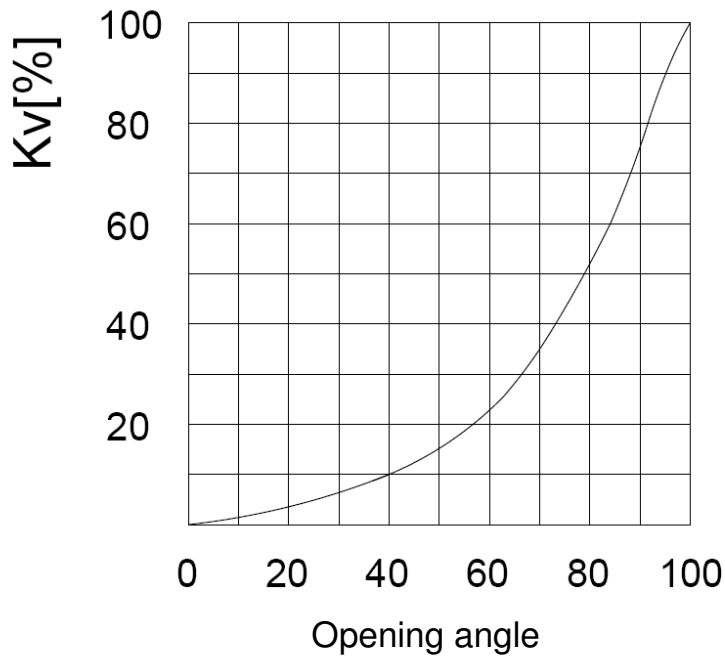

2-way Ball Valve S4 Pneumatic Actuator



Pressure-Temperature-Diagram **PVC**

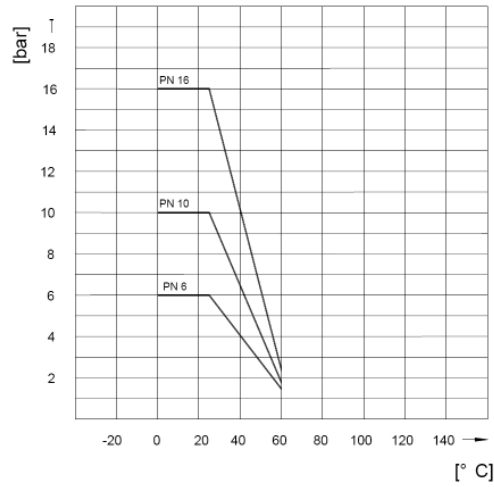

Pressure-Temperature-Diagram **PP**

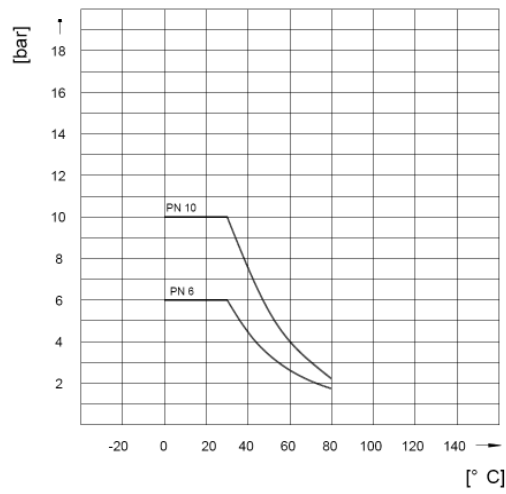

Pressure-Temperature-Diagram **PVDF**

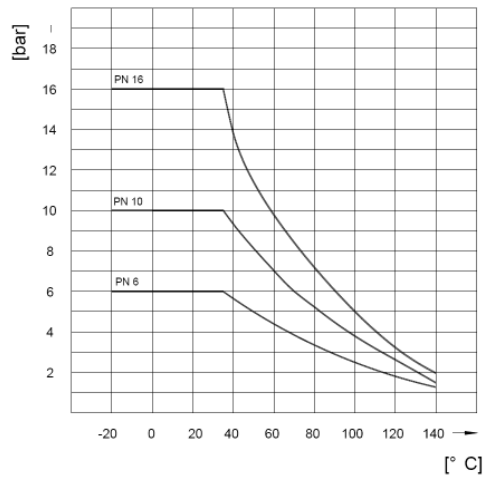

2-way Ball Valve S4 Pneumatic Actuator



Accessories:

AIR CONSUMPTION (FULL CYCLE) **DA DOUBLE ACTING**

Actuator	UT17 DA	UT20 DA	UT25 DA	UT35 DA
N. Lt.	0,55	0,71	1,10	2,45

AIR CONSUMPTION (FULL CYCLE) **SR SPRING RETURN**

Actuator	UT25 SR	UT30 SR	UT35 SR	UT45 SR	UT50 SR
N. Lt.	0,48	0,65	1,20	1,85	2,90

LIMIT SWITCH BOX



General Features

- Limit switch box with 2 mechanical switches
- Protection IP65
- Cable gland M20*1,5

Material

- Body: Polycarbonate black
- Cover: Polycarbonate with indicator
- Mounting bracket + screws: stainless steel
- Seals: EPDM

Voltage: 1-250 V

- Current:
- 16 A (250V AC)
- 2,5 A (24V DC)

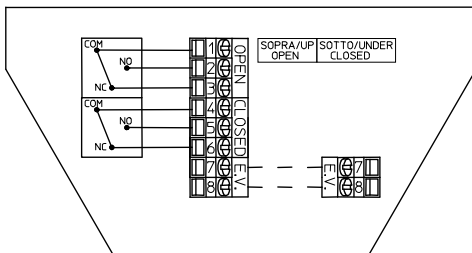

SOLENOID VALVE NAMUR



General Features

- Solenoid valve NAMUR with combined 5/2- and 3/2-ways function + standard coil
- Easy change from 5/2- to 3/2-way-function by innovative adaptor plates
- Manual override as standard

Material

- Body: Aluminium, anodised
- Piston: Aluminium
- Seals: NBR
- Screws and spring: stainless steel

Voltage:

- 24 V DC (3W)
- 230 V AC (5VA)

